

Stand portatili per fiera dritti

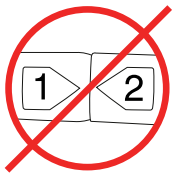

NO

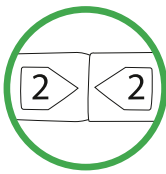

SI

Sistema facilitato di montaggio

Il sistema di montaggio è facilitato grazie alla numerazione delle sezioni dei profili.

Assemblare le diverse sezioni unendo tra loro quelle con lo stesso numero, unendo le sezioni tramite il pulsante a scatto.

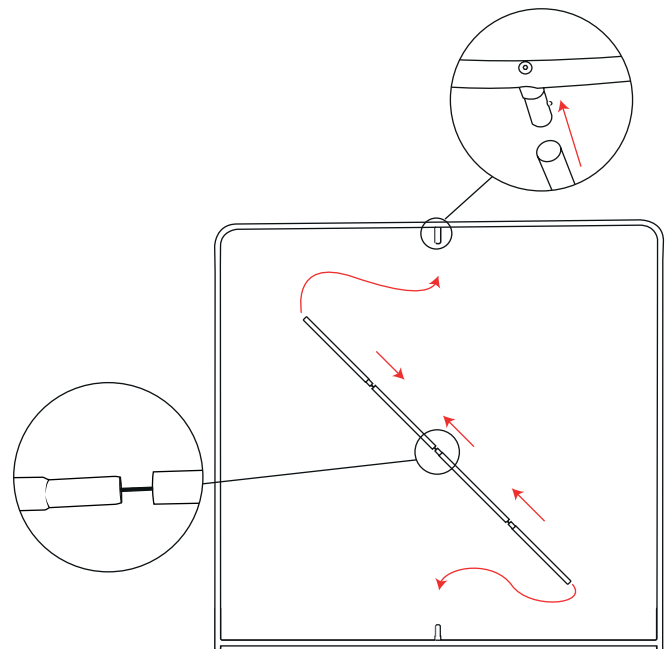
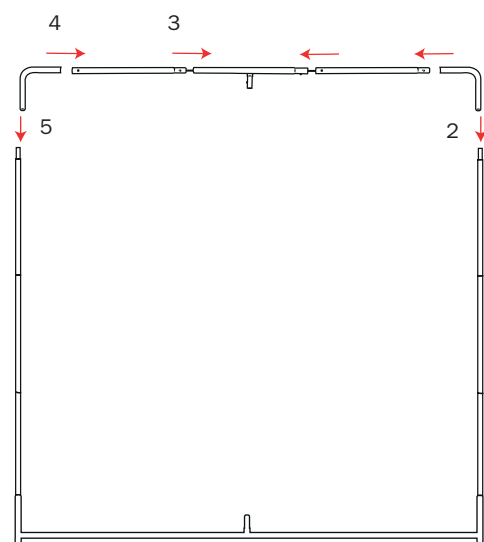
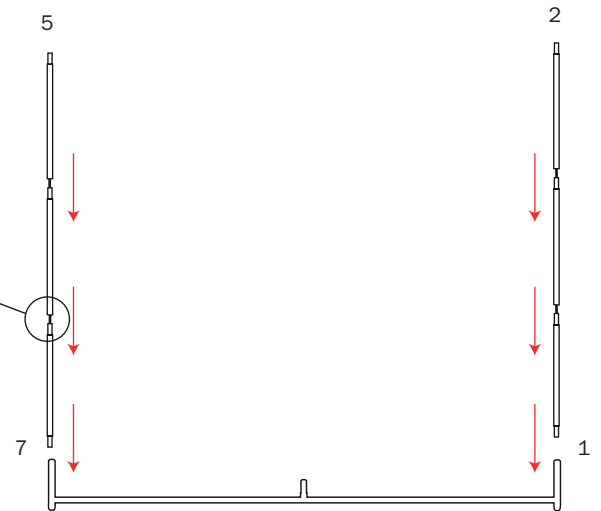
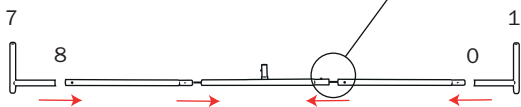
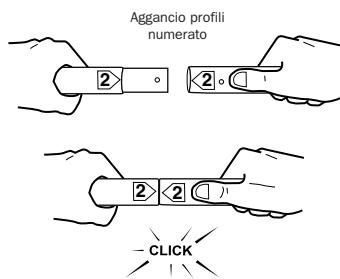

Stand portatili dritti

1 Inserisci la stampa dall'alto

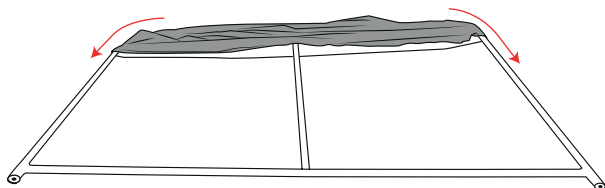

2 Fai scorrere la stampa lungo i profili verticali

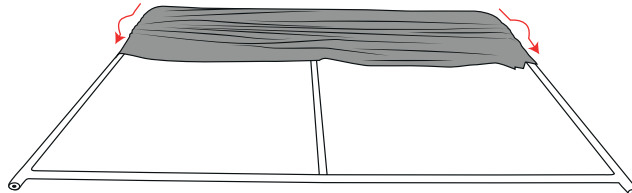

3 Fai scorrere lungo il lato sinistro

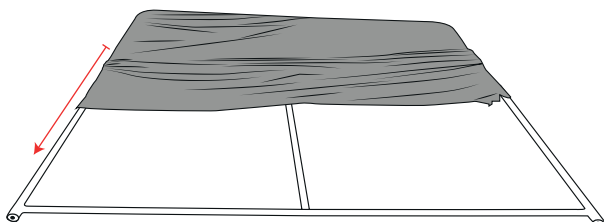

4 Fai scorrere lungo il lato destro

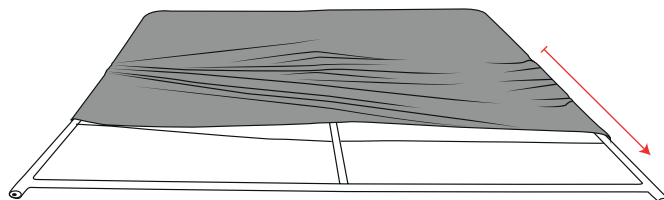

5 Chiudi la cerniera della stampa

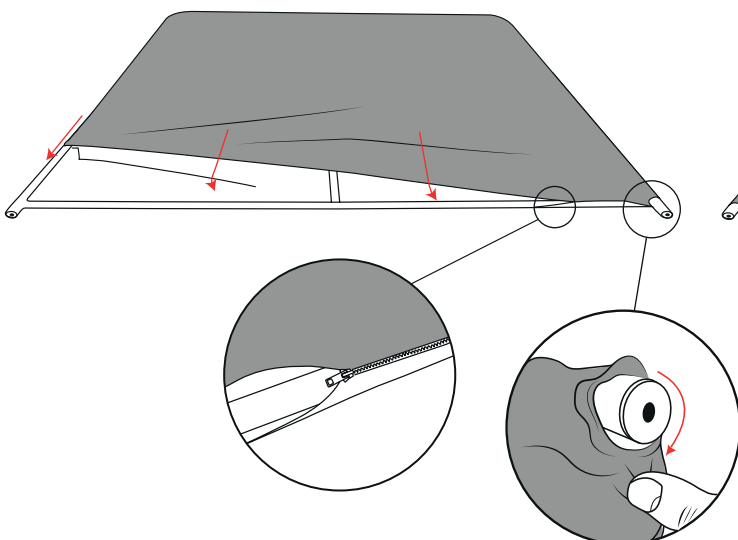

6 Inserisci i piedini portanti

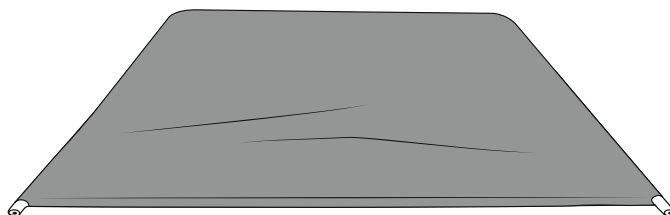

Stand portatili per fiera dritti

1 Accosta il piedino al profilo verticale

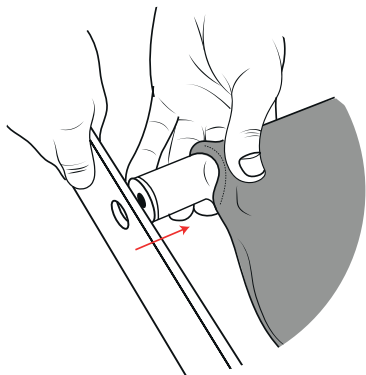

2 Insrisci la vite

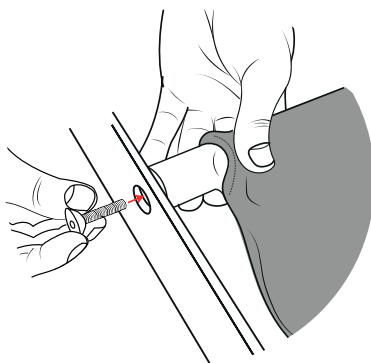

3 Avvita per serrare il piedino al profilo

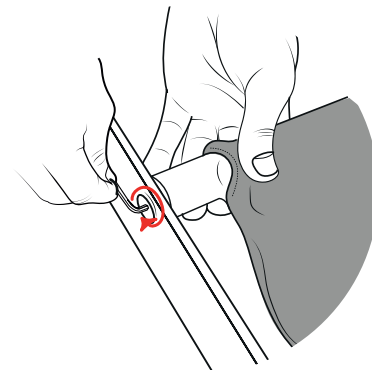

4 Ruota i piedini

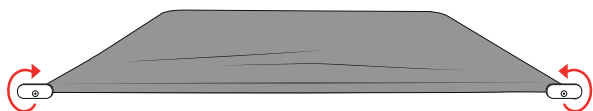

5 Ruota i piedini fino alla posizione ortogonale

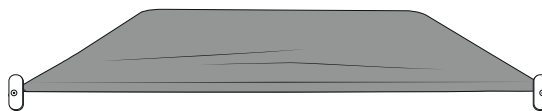

Piedini di sostegno



Borsa da trasporto

